

County of Lehigh Online Records Access
Property Details

Street View

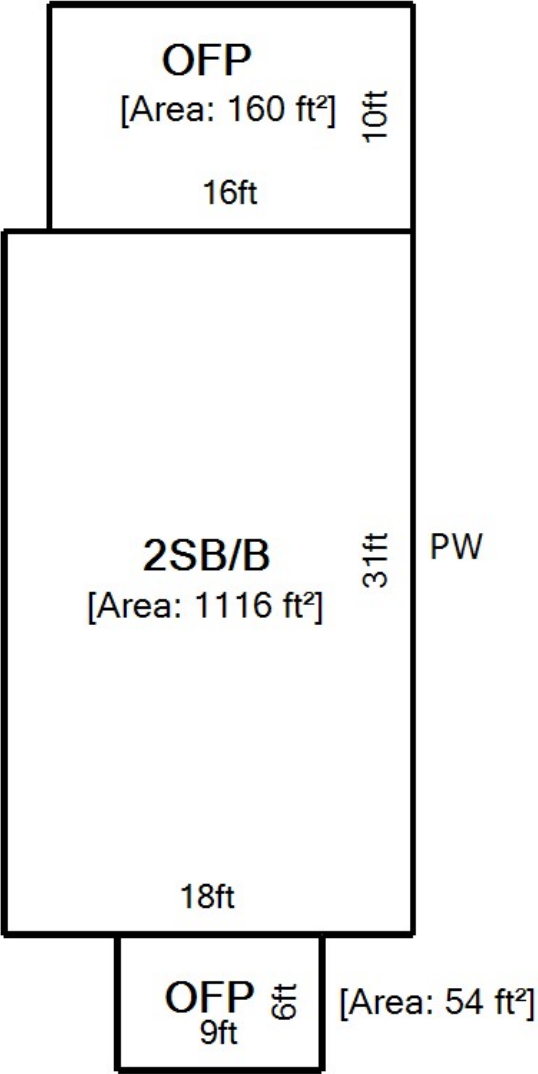



Property Overview

	2025			
Owner Name	WILLIAMS RICHARD			
Owner Address	136 5TH ST WHITEHALL PA 18052-7128			
Property Address	136 5TH ST WHITEHALL PA 18052			
Parcel Viewer	View in Parcel Viewer			
Low Number	0136			
High Number	0136			
Sub Division	JORDAN HILLS			
Tax Authority	WHITEHALL TOWNSHIP			
School District	WHITEHALL-COPLAY SCHOOL DISTRICT			
Parcel Id	640707369989 1			
Old Parcel Id	25 G09NE1C 022 002			
Tile	476001C			
Acres/Dimension	30 X 122.50			
Lot Sq Ft	3675			
Utilities	PUBLIC WATER/SEWER			
Class	RESIDENTIAL			
Land Use	SINGLE FAMILY - TWIN			
Living Units	1			
Zoning	R-5A			
Homestead Act 72	You may apply if it is your permanent primary residence.			
Preferential Land Act	NO			
Agricultural Easement	NO			
Assessment Base Year	2013			
Total Assessment	Exempt Land			0
	Exempt Building			0
	Taxable Land			14,100
	Taxable Building			80,600
	Total			94,700
	Taxable Total			94,700
Estimated Taxes	Mills			Estimated Taxes
	County		3.780000	\$ 357.97
	School		21.689800	\$ 2,054.02
	Municipality		3.850000	\$ 364.60
	Total			\$ 2,776.59
Bill Number	2509288			
LC_PropertyAddress	136 5TH ST WHITEHALL PA 18052			

Basic Residential Profile

Type of Residence	SINGLE FAMILY - TWIN
Number of Stories	2 STORY

Type of Construction	BRICK
Type of Basement	FULL
Type of Heating/Cooling	CENTRAL AIR
Type of Garage	NONE
Number of Full Bathrooms	1
Number of Half Bathrooms	0
Fireplaces	0
Square Feet	1116
Year Built	1942
Pool	NO POOL
Implement Buildings	NO IMPLEMENT BLDG

Residential Profile Data With No Influence on Assessment Value	
Total Rooms	6
Number of Bedrooms	3
Family Rooms	0

Sales History			
Sale Date	Owner Name	Document Id	Sale Price
10/2021	WILLIAMS RICHARD	2021047255	\$ 189,000
04/1962	WIGGINS JACK & ANNA	1012/0219	\$ 9,700

The building sketch represents the actual exterior measurement of the structure as measured from the outside. The sketch will show any attached areas and will be labeled with a descriptive code. Measurements are rounded to the nearest foot. Certain sketch dimensions and angles are drawn in approximation to their actual measurements.

The total square-foot area includes only the assessed living area of a residential structure, generally areas that are heated and/or cooled. Living area does not include porches, decks, patios, or garages.

Some of the common abbreviations are listed below for reference:

BUILDING STYLE	
CODE	DESCRIPTION
1S	1 STORY
1.5S	1½ STORY
2S	2 STORY
2.5S	2½ STORY
3S	3 STORY
3.5S	3½ STORY
B-L	BI-LEVEL
S-L	SPLIT-LEVEL

EXTERIOR	
CODE	DESCRIPTION
AV, A, V	ALUMINUM OR VINYL
B	BRICK
B&F	BRICK & FRAME
BFR	BRICK FRONT
BTR	BRICK TRIM
C	CONCRETE
CB	CONCRETE BLOCK
F, FR	FRAME
ST	STONE
SD	STUCCO OR DRYVIT
MTL	METAL
GL	GLASS

CODE	DESCRIPTION	CODE	DESCRIPTION
A	ATTIC	IGP	INGROUND POOL
BAL	BALCONY	LD	LOADING DOCK
B	BASEMENT	MP	MASONRY PATIO
BAY	BAY	MS	MASONRY SLAB
BSG	BASEMENT GARAGE	NB	NO BASEMENT
BW	BREEZEWAY	NA	NOT ADDED
BLT	BUILT	NI	NOT INCLUDED
CP	CARPORT	OFP	OPEN FRAME PORCH
CPY	CANOPY	OMP	OPEN MASONRY PORCH
CC	CATHEDRAL CEILING	OH	OVERHANG
CRLS	CRAWL SPACE	PB	PART BASEMENT
DECK	DECK	PW	PARTY WALL
EFP	ENCLOSED FRAME PORCH	RECRM	RECREATION ROOM
EMP	ENCLOSED MASONRY PORCH	S	SHED
FB	FINISHED BASEMENT	SQFT	SQUARE FOOT
FDN	FOUNDATION	STRG	STORAGE
G	GARAGE	UFB	UNFINISHED BASEMENT
GH	GREENHOUSE	WD	DECK

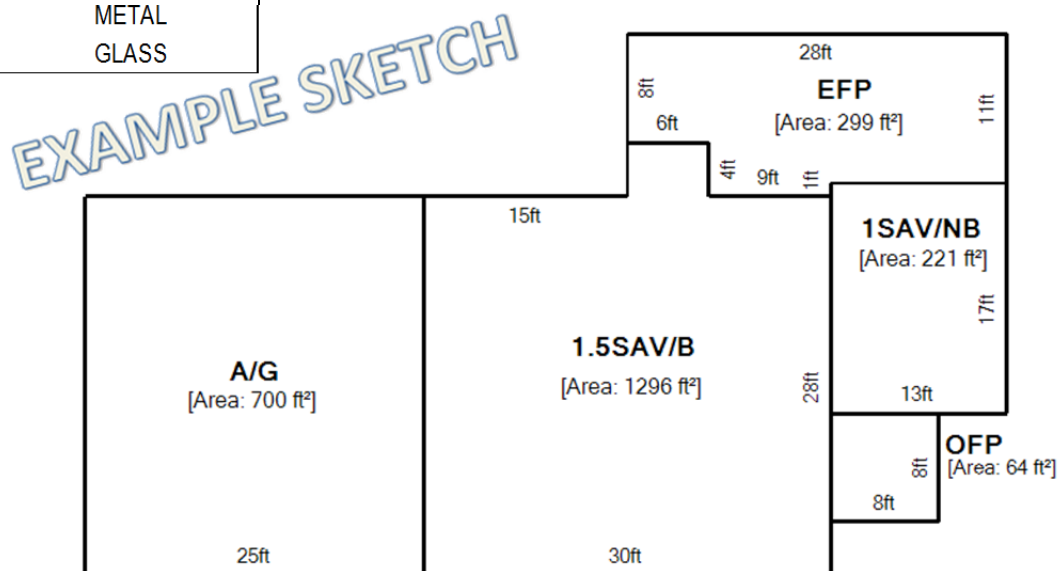

Information on this site is used for tax assessment purposes only and is subject to change without prior notice. The County of Lehigh Assessment Office assumes no responsibility for the use of the information for any other purpose. The use of information for any other purpose other than for tax assessment purposes is the sole and exclusive responsibility of the individual or entity using the information.