

County of Lehigh Online Records Access  
Property Details

Street View

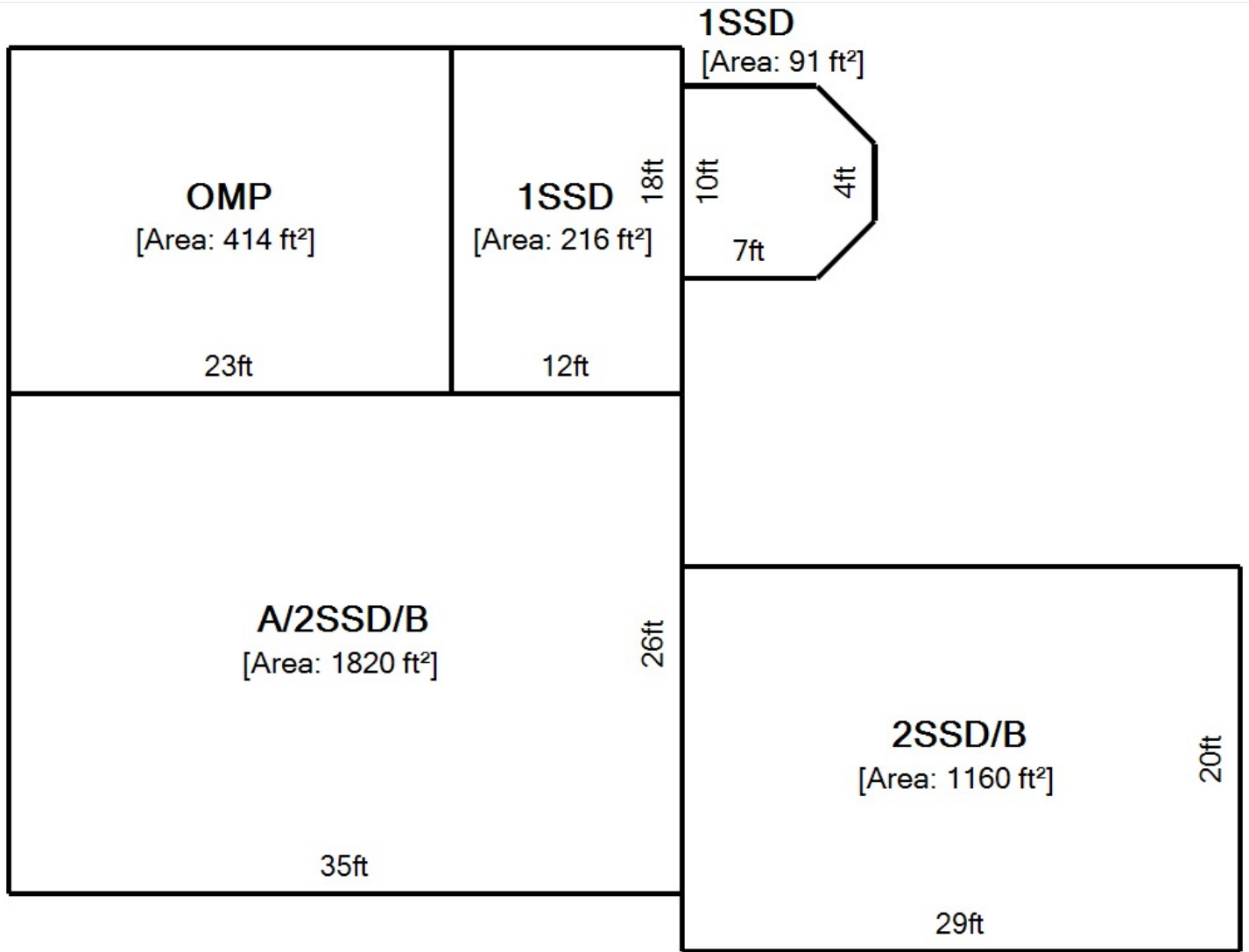



Property Overview

2026																			
<b>Owner Name</b>	DANIS STEVEN A																		
<b>Owner Address</b>	C-O DONALD HANNUM-ADVOC GUARDIAN SVC PO BOX 541 SKIPPACK PA 19474-0541																		
<b>Property Address</b>	4010 W TURNER ST ALLENTOWN PA 18104																		
<b>Parcel Viewer</b>	<a href="#">View in Parcel Viewer</a>																		
<b>Low Number</b>	4010																		
<b>High Number</b>	4010																		
<b>Sub Division</b>	STERLINGWORTH																		
<b>Tax Authority</b>	SOUTH WHITEHALL TOWNSHIP																		
<b>School District</b>	PARKLAND SCHOOL DISTRICT																		
<b>Parcel Id</b>	548613683424 1																		
<b>Old Parcel Id</b>	19 H08SW2 009 001																		
<b>Tile</b>	465809																		
<b>Acres/Dimension</b>	1.0704 AC																		
<b>Lot Sq Ft</b>	46628																		
<b>Utilities</b>	PUBLIC WATER/SEWER																		
<b>Class</b>	RESIDENTIAL																		
<b>Land Use</b>	SINGLE FAMILY - DETACHED																		
<b>Living Units</b>	1																		
<b>Zoning</b>	R-4																		
<b>Homestead Act 72</b>	Application Approved and Enrolled - 10/28/2004. Automatically Enrolled under Act 1 of 2006 as of 1/1/2007.																		
<b>Preferential Land Act</b>	NO																		
<b>Agricultural Easement</b>	NO																		
<b>Assessment Base Year</b>	2013																		
<b>Total Assessment</b>	<table border="1"> <tbody> <tr> <td>Exempt Land</td> <td></td> <td>0</td> </tr> <tr> <td>Exempt Building</td> <td></td> <td>0</td> </tr> <tr> <td>Taxable Land</td> <td></td> <td>79,500</td> </tr> <tr> <td>Taxable Building</td> <td></td> <td>227,300</td> </tr> <tr> <td>Total</td> <td></td> <td>306,800</td> </tr> <tr> <td>Taxable Total</td> <td></td> <td>306,800</td> </tr> </tbody> </table>	Exempt Land		0	Exempt Building		0	Taxable Land		79,500	Taxable Building		227,300	Total		306,800	Taxable Total		306,800
Exempt Land		0																	
Exempt Building		0																	
Taxable Land		79,500																	
Taxable Building		227,300																	
Total		306,800																	
Taxable Total		306,800																	
<b>Estimated Taxes</b>	<table border="1"> <thead> <tr> <th></th> <th>Mills</th> <th>Estimated Taxes</th> </tr> </thead> <tbody> <tr> <td>County</td> <td>3.780000</td> <td>\$ 1,159.70</td> </tr> <tr> <td>School</td> <td>17.900000</td> <td>\$ 5,491.72</td> </tr> <tr> <td>Municipality</td> <td>3.599750</td> <td>\$ 1,104.40</td> </tr> <tr> <td>Total</td> <td></td> <td>\$ 7,755.82</td> </tr> </tbody> </table> <p>Tax calculations do not reflect any reduction received due to enrollment in Homestead Act 72</p>		Mills	Estimated Taxes	County	3.780000	\$ 1,159.70	School	17.900000	\$ 5,491.72	Municipality	3.599750	\$ 1,104.40	Total		\$ 7,755.82			
	Mills	Estimated Taxes																	
County	3.780000	\$ 1,159.70																	
School	17.900000	\$ 5,491.72																	
Municipality	3.599750	\$ 1,104.40																	
Total		\$ 7,755.82																	
<b>Bill Number</b>	1901505																		
<b>LC_PropertyAddress</b>	4010 W TURNER ST ALLENTOWN PA 18104																		

Basic Residential Profile

<b>Type of Residence</b>	SINGLE FAMILY - DETACHED
--------------------------	--------------------------

<b>Number of Stories</b>	2 STORY
<b>Type of Construction</b>	STUCCO
<b>Type of Basement</b>	FULL
<b>Type of Heating/Cooling</b>	CENTRAL AIR
<b>Type of Garage</b>	NONE
<b>Number of Full Bathrooms</b>	2
<b>Number of Half Bathrooms</b>	1
<b>Fireplaces</b>	2
<b>Square Feet</b>	3287
<b>Year Built</b>	1880
<b>Pool</b>	NO POOL
<b>Implement Buildings</b>	NO IMPLEMENT BLDG

#### Residential Profile Data With No Influence on Assessment Value

<b>Total Rooms</b>	9
<b>Number of Bedrooms</b>	4
<b>Family Rooms</b>	1

#### Sales History

Sale Date	Owner Name	Document Id	Sale Price
07/2012	DANIS STEVEN A	2012041350	\$ 10
03/2011	DANIS STEVEN A & DEBORAH C	2011009624	\$ 1
11/2001	DANIS STEVEN A & DEBORAH C	1698/0635	\$ 364,000
05/1984	WILLS HENRY DONALD & JAN	1334/0324	\$ 222,500
00/0000	BARBER AMAN M JR & VALERIE	1077/0443	\$ 0

The building sketch represents the actual exterior measurement of the structure as measured from the outside. The sketch will show any attached areas and will be labeled with a descriptive code. Measurements are rounded to the nearest foot. Certain sketch dimensions and angles are drawn in approximation to their actual measurements.

The total square-foot area includes only the assessed living area of a residential structure, generally areas that are heated and/or cooled. Living area does not include porches, decks, patios, or garages.

Some of the common abbreviations are listed below for reference:

BUILDING STYLE	
CODE	DESCRIPTION
1S	1 STORY
1.5S	1½ STORY
2S	2 STORY
2.5S	2½ STORY
3S	3 STORY
3.5S	3½ STORY
B-L	BI-LEVEL
S-L	SPLIT-LEVEL

EXTERIOR	
CODE	DESCRIPTION
AV, A, V	ALUMINUM OR VINYL
B	BRICK
B&F	BRICK & FRAME
BFR	BRICK FRONT
BTR	BRICK TRIM
C	CONCRETE
CB	CONCRETE BLOCK
F, FR	FRAME
ST	STONE
SD	STUCCO OR DRYVIT
MTL	METAL
GL	GLASS

CODE	DESCRIPTION	CODE	DESCRIPTION
A	ATTIC	IGP	INGROUND POOL
BAL	BALCONY	LD	LOADING DOCK
B	BASEMENT	MP	MASONRY PATIO
BAY	BAY	MS	MASONRY SLAB
BSG	BASEMENT GARAGE	NB	NO BASEMENT
BW	BREEZEWAY	NA	NOT ADDED
BLT	BUILT	NI	NOT INCLUDED
CP	CARPORT	OFP	OPEN FRAME PORCH
CPY	CANOPY	OMP	OPEN MASONRY PORCH
CC	CATHEDRAL CEILING	OH	OVERHANG
CRLS	CRAWL SPACE	PB	PART BASEMENT
DECK	DECK	PW	PARTY WALL
EFP	ENCLOSED FRAME PORCH	RECRM	RECREATION ROOM
EMP	ENCLOSED MASONRY PORCH	S	SHED
FB	FINISHED BASEMENT	SQFT	SQUARE FOOT
FDN	FOUNDATION	STRG	STORAGE
G	GARAGE	UFB	UNFINISHED BASEMENT
GH	GREENHOUSE	WD	DECK

EXAMPLE SKETCH



Information on this site is used for tax assessment purposes only and is subject to change without prior notice. The County of Lehigh Assessment Office assumes no responsibility for the use of the information for any other purpose. The use of information for any other purpose other than for tax assessment purposes is the sole and exclusive responsibility of the individual or entity using the information.