

County of Lehigh Online Records Access
Property Details

Street View

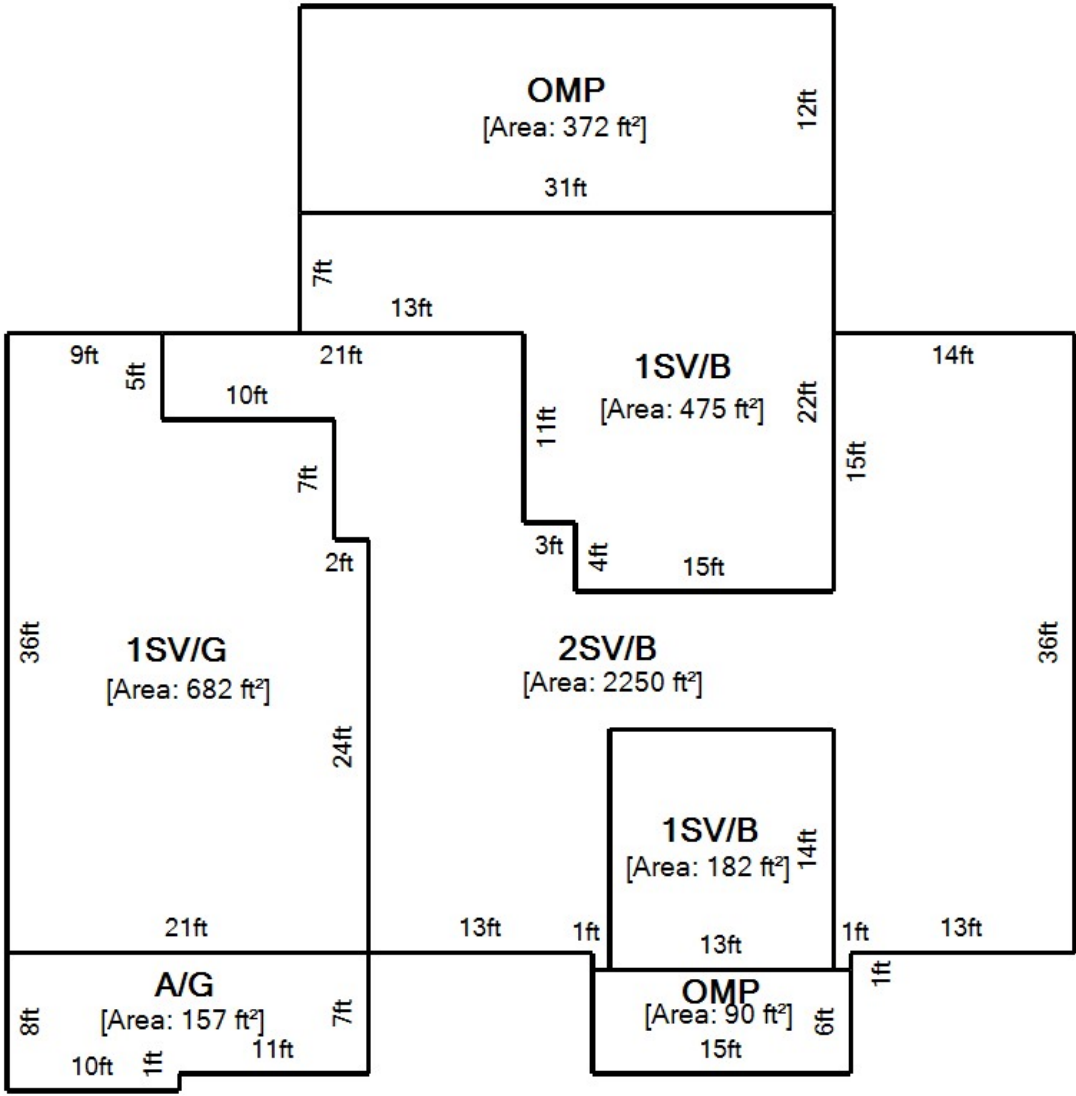



Property Overview

	2025		
Owner Name	CHEPONIS JONATHAN & KATHRYN E ESS		
Owner Address	268 SYLVIA LN ALLENTOWN PA 18104-9078		
Property Address	268 SYLVIA LN ALLENTOWN PA 18104		
Parcel Viewer	View in Parcel Viewer		
Low Number	0268		
High Number	0268		
Sub Division	TREETOP ESTATES		
Tax Authority	UPPER MACUNGIE TOWNSHIP		
School District	PARKLAND SCHOOL DISTRICT		
Parcel Id	547538089871 1		
Old Parcel Id	20 J07NE1 006 053		
Tile	455702		
Acres/Dimension	105.08 X 158.35 IRREG		
Lot Sq Ft	16788		
Utilities	PUBLIC WATER/SEWER		
Class	RESIDENTIAL		
Land Use	SINGLE FAMILY - DETACHED		
Living Units	1		
Zoning	R2		
Homestead Act 72	Application Approved and Enrolled - 01/10/2019		
Preferential Land Act	NO		
Agricultural Easement	NO		
Assessment Base Year	2013		
Total Assessment	Exempt Land		0
	Exempt Building		0
	Taxable Land		44,000
	Taxable Building		398,800
	Total		442,800
	Taxable Total		442,800
Estimated Taxes	Mills		Estimated Taxes
	County	3.780000	\$ 1,673.78
	School	17.220000	\$ 7,625.02
	Municipality	0.640000	\$ 283.39
	Total		\$ 9,582.19
Tax calculations do not reflect any reduction received due to enrollment in Homestead Act 72			
Bill Number	2001342		
LC_PropertyAddress	268 SYLVIA LN ALLENTOWN PA 18104		

Basic Residential Profile

Type of Residence	SINGLE FAMILY - DETACHED
--------------------------	--------------------------

Number of Stories	2 STORY
Type of Construction	ALUMINIUM/VINYL
Type of Basement	FULL
Type of Heating/Cooling	CENTRAL AIR
Type of Garage	ATTACHED TWO CAR OR MORE
Number of Full Bathrooms	5
Number of Half Bathrooms	0
Fireplaces	2
Square Feet	3589
Year Built	2004
Pool	NO POOL
Implement Buildings	NO IMPLEMENT BLDG

Residential Profile Data With No Influence on Assessment Value	
Total Rooms	9
Number of Bedrooms	4
Family Rooms	1

Sales History			
Sale Date	Owner Name	Document Id	Sale Price
08/2018	CHEPONIS JONATHAN & KATHRYN E ESS	2018022648	\$ 592,500
10/2004	ZENIE KARL T & MICHELLE M	7229815	\$ 589,000
09/2004	PRUDENTIAL RESIDENTIAL SERVICES LP	7229814	\$ 589,000
01/2004	GHATTAS MAURICE	7154112	\$ 539,990
01/1995	TREETOP ESTATES DEVELOPMENT CO	1539/1176	\$ 200,000

The building sketch represents the actual exterior measurement of the structure as measured from the outside. The sketch will show any attached areas and will be labeled with a descriptive code. Measurements are rounded to the nearest foot. Certain sketch dimensions and angles are drawn in approximation to their actual measurements.

The total square-foot area includes only the assessed living area of a residential structure, generally areas that are heated and/or cooled. Living area does not include porches, decks, patios, or garages.

Some of the common abbreviations are listed below for reference:

BUILDING STYLE	
CODE	DESCRIPTION
1S	1 STORY
1.5S	1½ STORY
2S	2 STORY
2.5S	2½ STORY
3S	3 STORY
3.5S	3½ STORY
B-L	BI-LEVEL
S-L	SPLIT-LEVEL

EXTERIOR	
CODE	DESCRIPTION
AV, A, V	ALUMINUM OR VINYL
B	BRICK
B&F	BRICK & FRAME
BFR	BRICK FRONT
BTR	BRICK TRIM
C	CONCRETE
CB	CONCRETE BLOCK
F, FR	FRAME
ST	STONE
SD	STUCCO OR DRYVIT
MTL	METAL
GL	GLASS

CODE	DESCRIPTION	CODE	DESCRIPTION
A	ATTIC	IGP	INGROUND POOL
BAL	BALCONY	LD	LOADING DOCK
B	BASEMENT	MP	MASONRY PATIO
BAY	BAY	MS	MASONRY SLAB
BSG	BASEMENT GARAGE	NB	NO BASEMENT
BW	BREEZEWAY	NA	NOT ADDED
BLT	BUILT	NI	NOT INCLUDED
CP	CARPORT	OFP	OPEN FRAME PORCH
CPY	CANOPY	OMP	OPEN MASONRY PORCH
CC	CATHEDRAL CEILING	OH	OVERHANG
CRLS	CRAWL SPACE	PB	PART BASEMENT
DECK	DECK	PW	PARTY WALL
EFP	ENCLOSED FRAME PORCH	RECRM	RECREATION ROOM
EMP	ENCLOSED MASONRY PORCH	S	SHED
FB	FINISHED BASEMENT	SQFT	SQUARE FOOT
FDN	FOUNDATION	STRG	STORAGE
G	GARAGE	UFB	UNFINISHED BASEMENT
GH	GREENHOUSE	WD	DECK

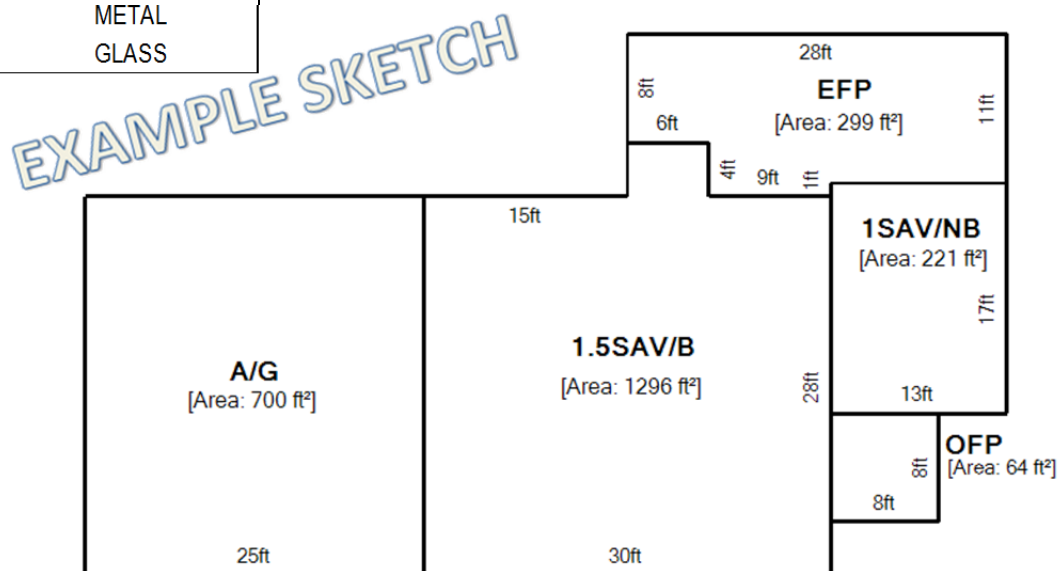

Information on this site is used for tax assessment purposes only and is subject to change without prior notice. The County of Lehigh Assessment Office assumes no responsibility for the use of the information for any other purpose. The use of information for any other purpose other than for tax assessment purposes is the sole and exclusive responsibility of the individual or entity using the information.