

County of Lehigh Online Records Access
Property Details

Street View

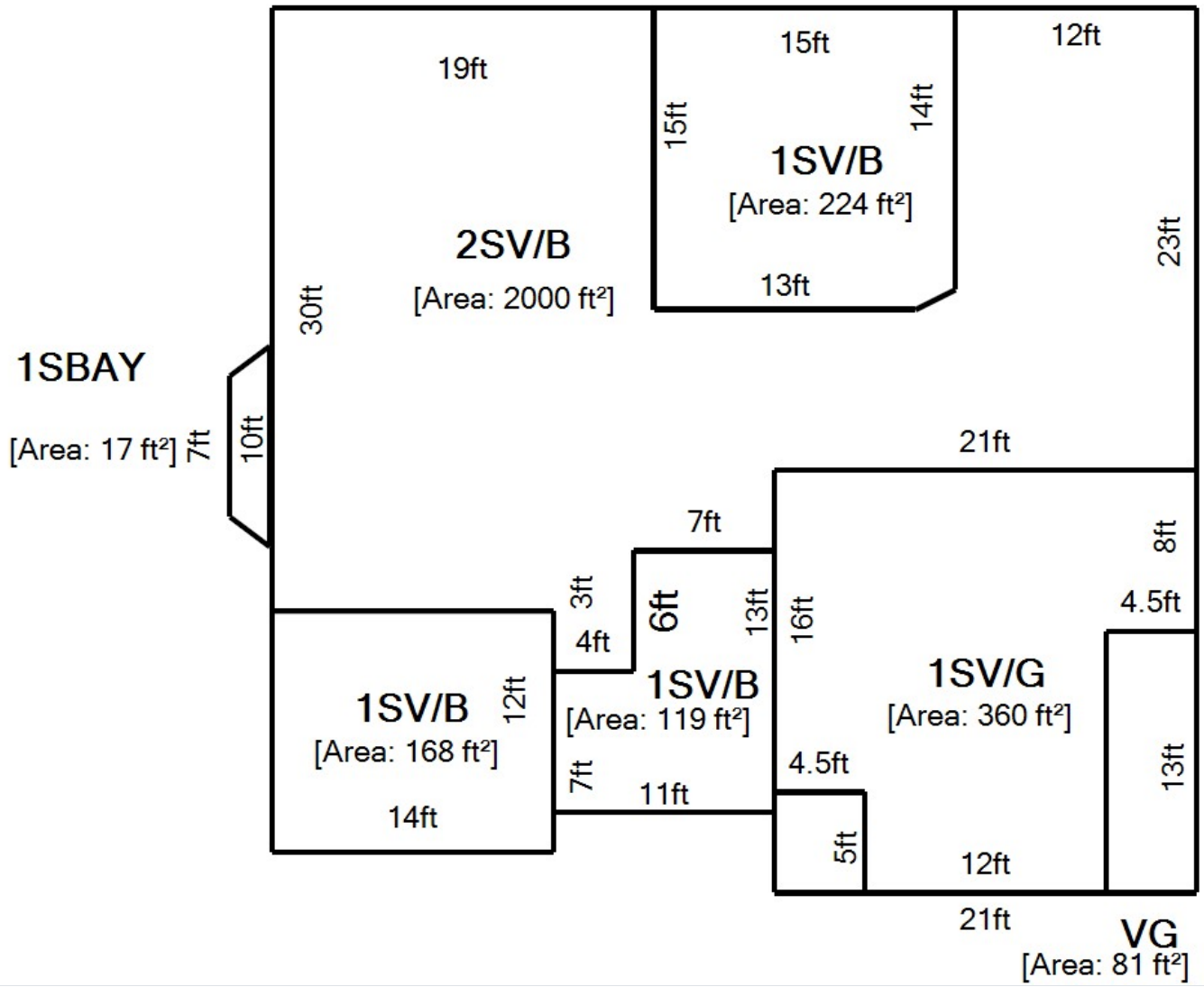



Property Overview

2026																
Owner Name	DWYER DANIEL & VISITACION															
Owner Address	7219 MCKEE CT MACUNGIE PA 18062-9598															
Property Address	7219 MCKEE CT MACUNGIE PA 18062															
Parcel Viewer	View in Parcel Viewer															
Low Number	7219															
High Number	7219															
Unit/Lot	353															
Sub Division	HILLS AT LOCK RIDGE															
Tax Authority	LOWER MACUNGIE TOWNSHIP															
School District	EAST PENN SCHOOL DISTRICT															
Parcel Id	547334161423 1															
Old Parcel Id	12															
Tile	435710															
Acres/Dimension	46.08 X 140.82 IRREG															
Lot Sq Ft	16113															
Utilities	PUBLIC WATER/SEWER															
Class	RESIDENTIAL															
Land Use	SINGLE FAMILY - DETACHED															
Living Units	1															
Zoning	R															
Homestead Act 72	Application Approved and Enrolled - 01/10/2008															
Preferential Land Act	NO															
Agricultural Easement	NO															
Assessment Base Year	2013															
Total Assessment	<table border="1"> <tbody> <tr> <td>Exempt Land</td> <td>0</td> </tr> <tr> <td>Exempt Building</td> <td>0</td> </tr> <tr> <td>Taxable Land</td> <td>37,600</td> </tr> <tr> <td>Taxable Building</td> <td>237,900</td> </tr> <tr> <td>Total</td> <td>275,500</td> </tr> <tr> <td>Taxable Total</td> <td>275,500</td> </tr> </tbody> </table>	Exempt Land	0	Exempt Building	0	Taxable Land	37,600	Taxable Building	237,900	Total	275,500	Taxable Total	275,500			
Exempt Land	0															
Exempt Building	0															
Taxable Land	37,600															
Taxable Building	237,900															
Total	275,500															
Taxable Total	275,500															
Estimated Taxes	<table border="1"> <thead> <tr> <th></th> <th>Mills</th> <th>Estimated Taxes</th> </tr> </thead> <tbody> <tr> <td>County</td> <td>3.780000</td> <td>\$ 1,041.39</td> </tr> <tr> <td>School</td> <td>21.840000</td> <td>\$ 6,016.92</td> </tr> <tr> <td>Municipality</td> <td>0.750000</td> <td>\$ 206.63</td> </tr> <tr> <td>Total</td> <td></td> <td>\$ 7,264.94</td> </tr> </tbody> </table> <p>Tax calculations do not reflect any reduction received due to enrollment in Homestead Act 72</p>		Mills	Estimated Taxes	County	3.780000	\$ 1,041.39	School	21.840000	\$ 6,016.92	Municipality	0.750000	\$ 206.63	Total		\$ 7,264.94
	Mills	Estimated Taxes														
County	3.780000	\$ 1,041.39														
School	21.840000	\$ 6,016.92														
Municipality	0.750000	\$ 206.63														
Total		\$ 7,264.94														
Bill Number	1207142															
LC_PropertyAddress	7219 MCKEE CT MACUNGIE PA 18062															

Basic Residential Profile

Type of Residence	SINGLE FAMILY - DETACHED
--------------------------	--------------------------

Number of Stories	2 STORY
Type of Construction	ALUMINIUM/VINYL
Type of Basement	FULL
Type of Heating/Cooling	CENTRAL AIR
Type of Garage	ATTACHED TWO CAR OR MORE
Number of Full Bathrooms	2
Number of Half Bathrooms	1
Fireplaces	1
Square Feet	2888
Year Built	2005
Pool	NO POOL
Implement Buildings	NO IMPLEMENT BLDG

Residential Profile Data With No Influence on Assessment Value

Total Rooms	9
Number of Bedrooms	4
Family Rooms	1

Sales History

Sale Date	Owner Name	Document Id	Sale Price
02/2006	DWYER DANIEL & VISITACION	7325111	\$ 355,105
07/2005	T H PROPERTIES LP	7278261	\$ 3,595,400
/0000	NEW PARCEL	0000000	\$ 0

The building sketch represents the actual exterior measurement of the structure as measured from the outside. The sketch will show any attached areas and will be labeled with a descriptive code. Measurements are rounded to the nearest foot. Certain sketch dimensions and angles are drawn in approximation to their actual measurements.

The total square-foot area includes only the assessed living area of a residential structure, generally areas that are heated and/or cooled. Living area does not include porches, decks, patios, or garages.

Some of the common abbreviations are listed below for reference:

BUILDING STYLE	
CODE	DESCRIPTION
1S	1 STORY
1.5S	1½ STORY
2S	2 STORY
2.5S	2½ STORY
3S	3 STORY
3.5S	3½ STORY
B-L	BI-LEVEL
S-L	SPLIT-LEVEL

EXTERIOR	
CODE	DESCRIPTION
AV, A, V	ALUMINUM OR VINYL
B	BRICK
B&F	BRICK & FRAME
BFR	BRICK FRONT
BTR	BRICK TRIM
C	CONCRETE
CB	CONCRETE BLOCK
F, FR	FRAME
ST	STONE
SD	STUCCO OR DRYVIT
MTL	METAL
GL	GLASS

CODE	DESCRIPTION	CODE	DESCRIPTION
A	ATTIC	IGP	INGROUND POOL
BAL	BALCONY	LD	LOADING DOCK
B	BASEMENT	MP	MASONRY PATIO
BAY	BAY	MS	MASONRY SLAB
BSG	BASEMENT GARAGE	NB	NO BASEMENT
BW	BREEZEWAY	NA	NOT ADDED
BLT	BUILT	NI	NOT INCLUDED
CP	CARPORT	OFP	OPEN FRAME PORCH
CPY	CANOPY	OMP	OPEN MASONRY PORCH
CC	CATHEDRAL CEILING	OH	OVERHANG
CRLS	CRAWL SPACE	PB	PART BASEMENT
DECK	DECK	PW	PARTY WALL
EFP	ENCLOSED FRAME PORCH	RECRM	RECREATION ROOM
EMP	ENCLOSED MASONRY PORCH	S	SHED
FB	FINISHED BASEMENT	SQFT	SQUARE FOOT
FDN	FOUNDATION	STRG	STORAGE
G	GARAGE	UFB	UNFINISHED BASEMENT
GH	GREENHOUSE	WD	DECK

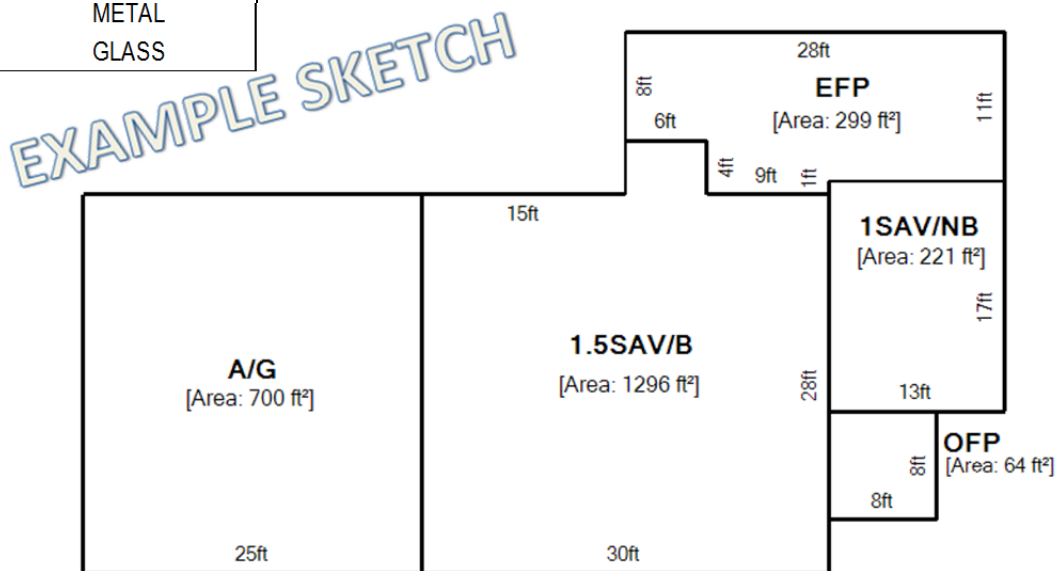

Information on this site is used for tax assessment purposes only and is subject to change without prior notice. The County of Lehigh Assessment Office assumes no responsibility for the use of the information for any other purpose. The use of information for any other purpose other than for tax assessment purposes is the sole and exclusive responsibility of the individual or entity using the information.