

County of Lehigh Online Records Access
Property Details

Street View

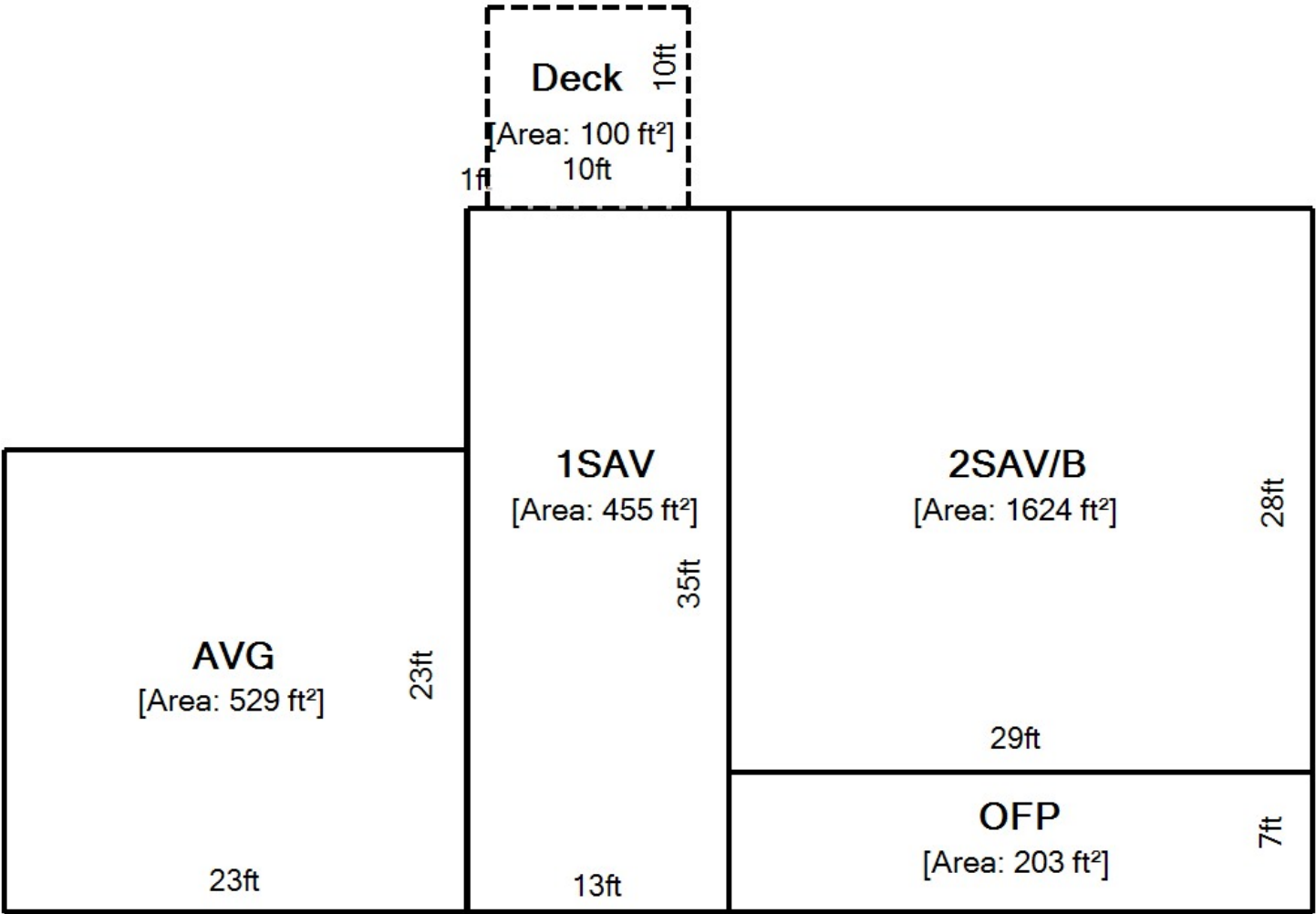



232'BTR

Property Overview

	2025		
Owner Name	DUNN DIANA S & HERBERT C KLOTZ		
Owner Address	1844 PINE NEEDLE CV FOGELSVILLE PA 18051-1529		
Property Address	1844 PINE NEEDLE CV FOGELSVILLE PA 18051		
Parcel Viewer	View in Parcel Viewer		
Low Number	1844		
High Number	1844		
Sub Division	APPLEWOOD		
Tax Authority	UPPER MACUNGIE TOWNSHIP		
School District	PARKLAND SCHOOL DISTRICT		
Parcel Id	545636763498 1		
Old Parcel Id	20 H06NW3 008 022		
Tile	465506		
Acres/Dimension	98.61 X 138.53 IRREG		
Lot Sq Ft	16335		
Utilities	PUBLIC WATER/SEWER		
Class	RESIDENTIAL		
Land Use	SINGLE FAMILY - DETACHED		
Living Units	1		
Zoning	R1		
Homestead Act 72	Application Approved and Enrolled - 01/16/2008		
Preferential Land Act	NO		
Agricultural Easement	NO		
Assessment Base Year	2013		
Total Assessment	Exempt Land		0
	Exempt Building		0
	Taxable Land		42,900
	Taxable Building		198,900
	Total		241,800
	Taxable Total		241,800
Estimated Taxes	Mills		Estimated Taxes
	County	3.780000	\$ 914.00
	School	17.900000	\$ 4,328.22
	Municipality	0.640000	\$ 154.75
	Total		\$ 5,396.97
Tax calculations do not reflect any reduction received due to enrollment in Homestead Act 72			
Bill Number	2002358		
LC_PropertyAddress	1844 PINE NEEDLE CV FOGELSVILLE PA 18051		

Basic Residential Profile

Type of Residence	SINGLE FAMILY - DETACHED
--------------------------	--------------------------

Number of Stories	2 STORY
Type of Construction	ALUMINIUM/VINYL
Type of Basement	FULL
Type of Heating/Cooling	CENTRAL AIR
Type of Garage	ATTACHED TWO CAR OR MORE
Number of Full Bathrooms	2
Number of Half Bathrooms	1
Fireplaces	1
Square Feet	2079
Year Built	1981
Pool	NO POOL
Implement Buildings	NO IMPLEMENT BLDG

Residential Profile Data With No Influence on Assessment Value	
Total Rooms	8
Number of Bedrooms	3
Family Rooms	1

Sales History			
Sale Date	Owner Name	Document Id	Sale Price
10/2024	DUNN DIANA S & HERBERT C KLOTZ	2024025961	\$ 1
04/2007	DUNN DIANA S	7409576	\$ 324,000
10/1998	CHRISTMAN JOHN T & ALICE K	1619/1155	\$ 155,000
05/1989	CHRISTMAN THOMAS H & GLORIA	1435/0757	\$ 180,000
07/1981	HINKEL ROBERT O & PATRICIA A	1296/0365	\$ 105,800

The building sketch represents the actual exterior measurement of the structure as measured from the outside. The sketch will show any attached areas and will be labeled with a descriptive code. Measurements are rounded to the nearest foot. Certain sketch dimensions and angles are drawn in approximation to their actual measurements.

The total square-foot area includes only the assessed living area of a residential structure, generally areas that are heated and/or cooled. Living area does not include porches, decks, patios, or garages.

Some of the common abbreviations are listed below for reference:

BUILDING STYLE	
CODE	DESCRIPTION
1S	1 STORY
1.5S	1½ STORY
2S	2 STORY
2.5S	2½ STORY
3S	3 STORY
3.5S	3½ STORY
B-L	BI-LEVEL
S-L	SPLIT-LEVEL

EXTERIOR	
CODE	DESCRIPTION
AV, A, V	ALUMINUM OR VINYL
B	BRICK
B&F	BRICK & FRAME
BFR	BRICK FRONT
BTR	BRICK TRIM
C	CONCRETE
CB	CONCRETE BLOCK
F, FR	FRAME
ST	STONE
SD	STUCCO OR DRYVIT
MTL	METAL
GL	GLASS

CODE	DESCRIPTION	CODE	DESCRIPTION
A	ATTIC	IGP	INGROUND POOL
BAL	BALCONY	LD	LOADING DOCK
B	BASEMENT	MP	MASONRY PATIO
BAY	BAY	MS	MASONRY SLAB
BSG	BASEMENT GARAGE	NB	NO BASEMENT
BW	BREEZEWAY	NA	NOT ADDED
BLT	BUILT	NI	NOT INCLUDED
CP	CARPORT	OFP	OPEN FRAME PORCH
CPY	CANOPY	OMP	OPEN MASONRY PORCH
CC	CATHEDRAL CEILING	OH	OVERHANG
CRLS	CRAWL SPACE	PB	PART BASEMENT
DECK	DECK	PW	PARTY WALL
EFP	ENCLOSED FRAME PORCH	RECRM	RECREATION ROOM
EMP	ENCLOSED MASONRY PORCH	S	SHED
FB	FINISHED BASEMENT	SQFT	SQUARE FOOT
FDN	FOUNDATION	STRG	STORAGE
G	GARAGE	UFB	UNFINISHED BASEMENT
GH	GREENHOUSE	WD	DECK

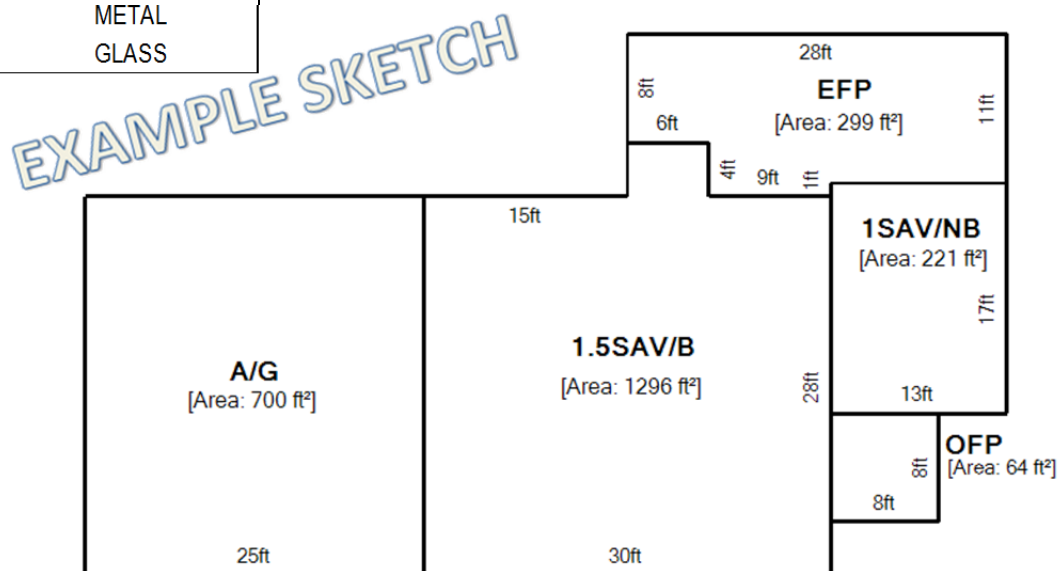

Information on this site is used for tax assessment purposes only and is subject to change without prior notice. The County of Lehigh Assessment Office assumes no responsibility for the use of the information for any other purpose. The use of information for any other purpose other than for tax assessment purposes is the sole and exclusive responsibility of the individual or entity using the information.