

**County of Lehigh Online Records Access**  
Property Details

Street View

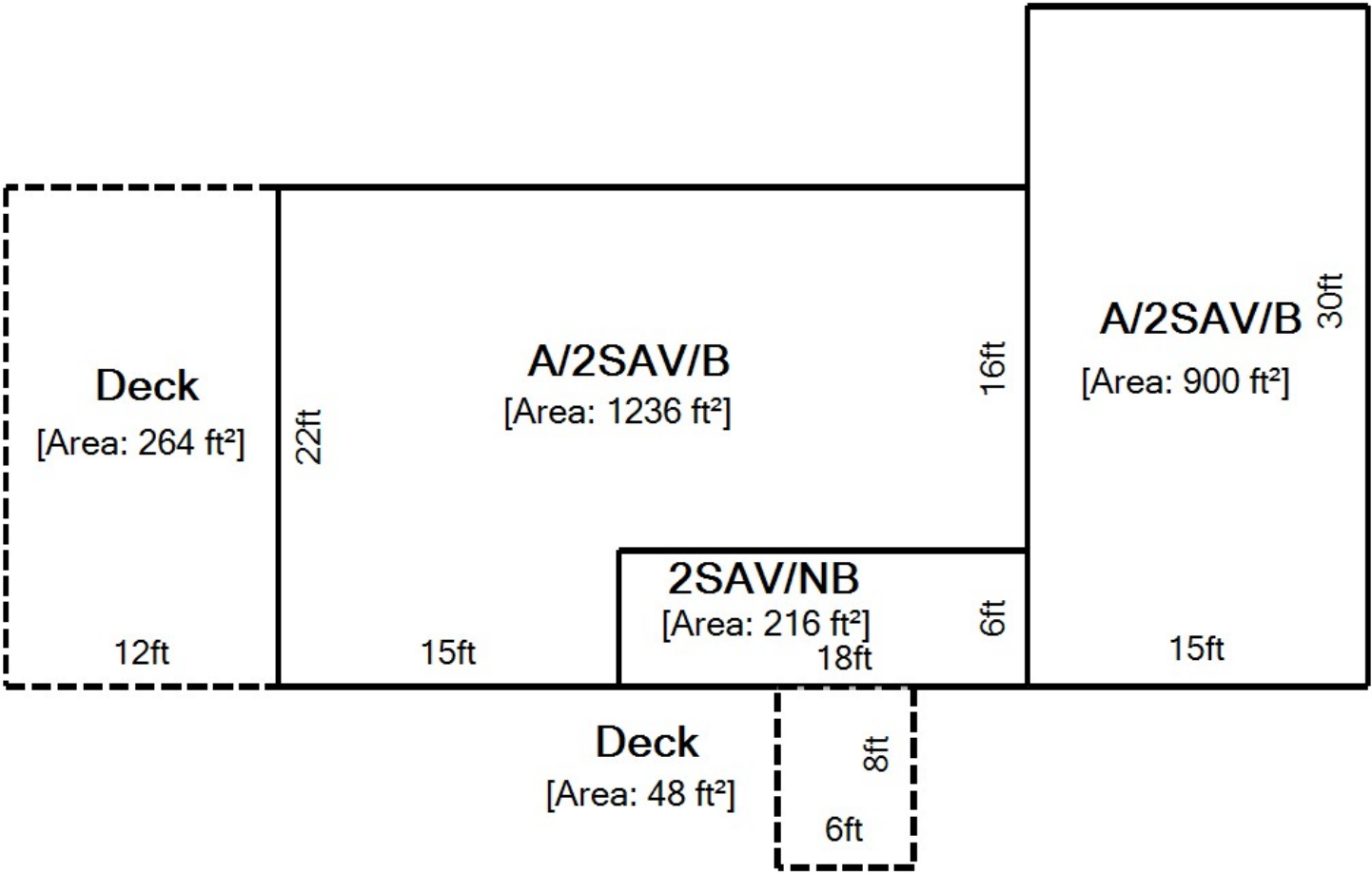



## Property Overview

	2025		
<b>Owner Name</b>	CONROY PAMELA GRACE		
<b>Owner Address</b>	7690 DRESHER RD KEMPTON PA 19529-8961		
<b>Property Address</b>	7690 DRESHER RD KEMPTON PA 19529		
<b>Parcel Viewer</b>	<a href="#">View in Parcel Viewer</a>		
<b>Low Number</b>	7690		
<b>High Number</b>	7690		
<b>Tax Authority</b>	LYNN TOWNSHIP		
<b>School District</b>	NORTHWESTERN SCHOOL DISTRICT		
<b>Parcel Id</b>	448981979884 1		
<b>Old Parcel Id</b>	14 E01 001 047		
<b>Tile</b>	494800		
<b>Acres/Dimension</b>	3.4 ACRES		
<b>Lot Sq Ft</b>	148104		
<b>Utilities</b>	NONE		
<b>Class</b>	RESIDENTIAL		
<b>Land Use</b>	SINGLE FAMILY - DETACHED		
<b>Living Units</b>	1		
<b>Zoning</b>	AP		
<b>Homestead Act 72</b>	Application Approved and Enrolled - 01/13/2015		
<b>Preferential Land Act</b>	NO		
<b>Agricultural Easement</b>	NO		
<b>Assessment Base Year</b>	2013		
<b>Total Assessment</b>	Exempt Land		0
	Exempt Building		0
	Taxable Land		90,700
	Taxable Building		135,200
	Total		225,900
	Taxable Total		225,900
<b>Estimated Taxes</b>	<b>Mills</b>		<b>Estimated Taxes</b>
	County	3.780000	\$ 853.90
	School	20.102500	\$ 4,541.15
	Municipality	0.200000	\$ 45.18
	Total		\$ 5,440.23
Tax calculations do not reflect any reduction received due to enrollment in Homestead Act 72			
<b>Bill Number</b>	1400329		
<b>LC_PropertyAddress</b>	7690 DRESHER RD KEMPTON PA 19529		

## Basic Residential Profile

<b>Type of Residence</b>	SINGLE FAMILY - DETACHED
<b>Number of Stories</b>	2 1/2 STORY

Type of Construction	ALUMINIUM/VINYL
Type of Basement	FULL
Type of Heating/Cooling	BASE
Type of Garage	DETACHED TWO CAR OR MORE
Number of Full Bathrooms	2
Number of Half Bathrooms	1
Fireplaces	1
Square Feet	2352
Year Built	1875
Pool	NO POOL
Implement Buildings	(2) OUTBUILDINGS

Residential Profile Data With No Influence on Assessment Value	
Total Rooms	6
Number of Bedrooms	3
Family Rooms	0

Sales History			
Sale Date	Owner Name	Document Id	Sale Price
11/2020	CONROY PAMELA GRACE	2020043433	\$ 112,950
03/2018	CONROY PAMELA G & R NICHOLS-CONROY	2018008700	\$ 1
12/2013	CONROY PAMELA GRACE ET AL	2013046244	\$ 220,000
03/2013	SNYDER CODY L	2013011527	\$ 68,973
08/2003	BLEILER SUSAN J & IRWIN W FUSSELMAN	7114952	\$ 30,000

The building sketch represents the actual exterior measurement of the structure as measured from the outside. The sketch will show any attached areas and will be labeled with a descriptive code. Measurements are rounded to the nearest foot. Certain sketch dimensions and angles are drawn in approximation to their actual measurements.

The total square-foot area includes only the assessed living area of a residential structure, generally areas that are heated and/or cooled. Living area does not include porches, decks, patios, or garages.

Some of the common abbreviations are listed below for reference:

BUILDING STYLE	
CODE	DESCRIPTION
1S	1 STORY
1.5S	1½ STORY
2S	2 STORY
2.5S	2½ STORY
3S	3 STORY
3.5S	3½ STORY
B-L	BI-LEVEL
S-L	SPLIT-LEVEL

EXTERIOR	
CODE	DESCRIPTION
AV, A, V	ALUMINUM OR VINYL
B	BRICK
B&F	BRICK & FRAME
BFR	BRICK FRONT
BTR	BRICK TRIM
C	CONCRETE
CB	CONCRETE BLOCK
F, FR	FRAME
ST	STONE
SD	STUCCO OR DRYVIT
MTL	METAL
GL	GLASS

CODE	DESCRIPTION	CODE	DESCRIPTION
A	ATTIC	IGP	INGROUND POOL
BAL	BALCONY	LD	LOADING DOCK
B	BASEMENT	MP	MASONRY PATIO
BAY	BAY	MS	MASONRY SLAB
BSG	BASEMENT GARAGE	NB	NO BASEMENT
BW	BREEZEWAY	NA	NOT ADDED
BLT	BUILT	NI	NOT INCLUDED
CP	CARPORT	OFP	OPEN FRAME PORCH
CPY	CANOPY	OMP	OPEN MASONRY PORCH
CC	CATHEDRAL CEILING	OH	OVERHANG
CRLS	CRAWL SPACE	PB	PART BASEMENT
DECK	DECK	PW	PARTY WALL
EFP	ENCLOSED FRAME PORCH	RECRM	RECREATION ROOM
EMP	ENCLOSED MASONRY PORCH	S	SHED
FB	FINISHED BASEMENT	SQFT	SQUARE FOOT
FDN	FOUNDATION	STRG	STORAGE
G	GARAGE	UFB	UNFINISHED BASEMENT
GH	GREENHOUSE	WD	DECK

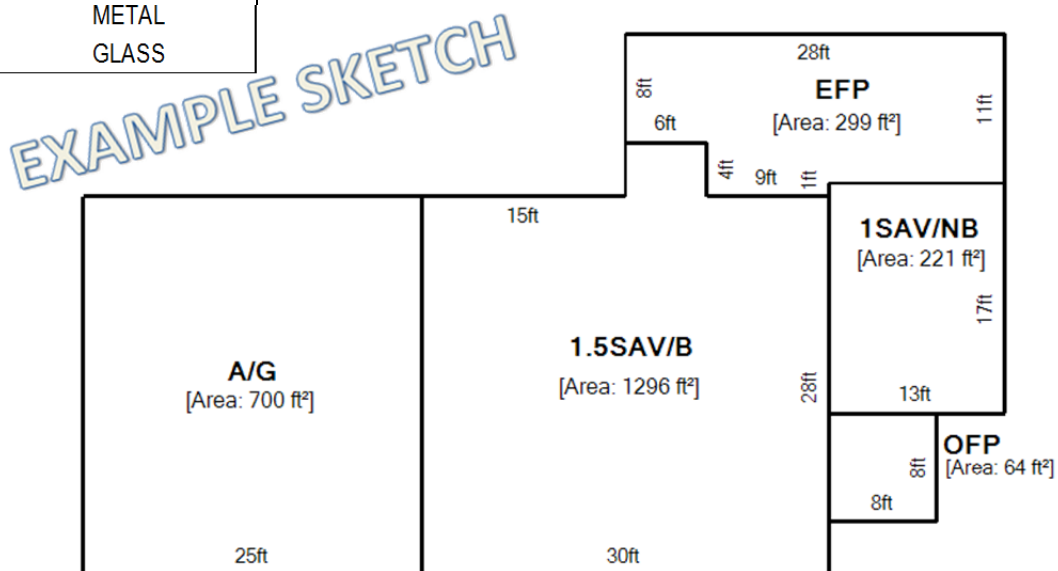

Information on this site is used for tax assessment purposes only and is subject to change without prior notice. The County of Lehigh Assessment Office assumes no responsibility for the use of the information for any other purpose. The use of information for any other purpose other than for tax assessment purposes is the sole and exclusive responsibility of the individual or entity using the information.