

County of Lehigh Online Records Access
Property Details

Street View

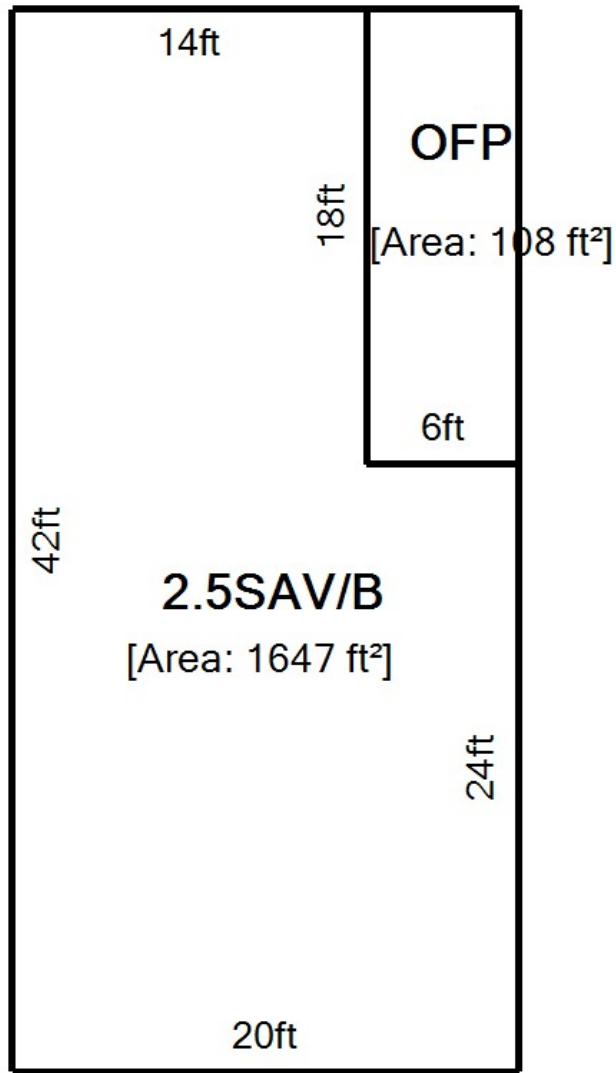



Property Overview

	2025		
Owner Name	KRISZAT E FRED		
Owner Address	7666 DRESHER RD KEMPTON PA 19529-8961		
Property Address	7666 DRESHER RD KEMPTON PA 19529		
Parcel Viewer	View in Parcel Viewer		
Low Number	7666		
High Number	7666		
Tax Authority	LYNN TOWNSHIP		
School District	NORTHWESTERN SCHOOL DISTRICT		
Parcel Id	448981934090 1		
Old Parcel Id	14 E01 001 046		
Tile	494800		
Acres/Dimension	2.3 ACRES		
Lot Sq Ft	100188		
Utilities	NONE		
Class	RESIDENTIAL		
Land Use	SINGLE FAMILY - DETACHED		
Living Units	1		
Zoning	AP		
Homestead Act 72	Application Approved and Enrolled - 10/29/2004. Automatically Enrolled under Act 1 of 2006 as of 1/1/2007.		
Preferential Land Act	NO		
Agricultural Easement	NO		
Assessment Base Year	2013		
Total Assessment			
	Exempt Land		0
	Exempt Building		0
	Taxable Land		78,900
	Taxable Building		103,600
	Total		182,500
	Taxable Total		182,500
Estimated Taxes	Mills		Estimated Taxes
	County	3.780000	\$ 689.85
	School	20.102500	\$ 3,668.71
	Municipality	0.200000	\$ 36.50
	Total		\$ 4,395.06
	Tax calculations do not reflect any reduction received due to enrollment in Homestead Act 72		
Bill Number	1401170		
LC_PropertyAddress	7666 DRESHER RD KEMPTON PA 19529		

Basic Residential Profile

Type of Residence	SINGLE FAMILY - DETACHED
Number of Stories	2 1/2 STORY

Type of Construction	ALUMINIUM/VINYL
Type of Basement	FULL
Type of Heating/Cooling	BASE
Type of Garage	DETACHED TWO CAR OR MORE
Number of Full Bathrooms	1
Number of Half Bathrooms	0
Fireplaces	0
Square Feet	1647
Year Built	1890
Pool	NO POOL
Implement Buildings	(1) OUTBUILDING

Residential Profile Data With No Influence on Assessment Value

Total Rooms	6
Number of Bedrooms	3
Family Rooms	0

Sales History

Sale Date	Owner Name	Document Id	Sale Price
03/2001	KRISZAT E FRED	1682/0373	\$ 124,000
01/2000	HEFFNER WARREN W ESTATE	1658/0685	\$ 1
10/1996	HEFFNER WARREN W TRUST	1630/1153	\$ 1
07/1982	HEFFNER WARREN W	1308/1065	\$ 1
00/0000	HEFFNER MARGARET	1118/0466	\$ 0

The building sketch represents the actual exterior measurement of the structure as measured from the outside. The sketch will show any attached areas and will be labeled with a descriptive code. Measurements are rounded to the nearest foot. Certain sketch dimensions and angles are drawn in approximation to their actual measurements.

The total square-foot area includes only the assessed living area of a residential structure, generally areas that are heated and/or cooled. Living area does not include porches, decks, patios, or garages.

Some of the common abbreviations are listed below for reference:

BUILDING STYLE	
CODE	DESCRIPTION
1S	1 STORY
1.5S	1½ STORY
2S	2 STORY
2.5S	2½ STORY
3S	3 STORY
3.5S	3½ STORY
B-L	BI-LEVEL
S-L	SPLIT-LEVEL

EXTERIOR	
CODE	DESCRIPTION
AV, A, V	ALUMINUM OR VINYL
B	BRICK
B&F	BRICK & FRAME
BFR	BRICK FRONT
BTR	BRICK TRIM
C	CONCRETE
CB	CONCRETE BLOCK
F, FR	FRAME
ST	STONE
SD	STUCCO OR DRYVIT
MTL	METAL
GL	GLASS

CODE	DESCRIPTION	CODE	DESCRIPTION
A	ATTIC	IGP	INGROUND POOL
BAL	BALCONY	LD	LOADING DOCK
B	BASEMENT	MP	MASONRY PATIO
BAY	BAY	MS	MASONRY SLAB
BSG	BASEMENT GARAGE	NB	NO BASEMENT
BW	BREEZEWAY	NA	NOT ADDED
BLT	BUILT	NI	NOT INCLUDED
CP	CARPORT	OFP	OPEN FRAME PORCH
CPY	CANOPY	OMP	OPEN MASONRY PORCH
CC	CATHEDRAL CEILING	OH	OVERHANG
CRLS	CRAWL SPACE	PB	PART BASEMENT
DECK	DECK	PW	PARTY WALL
EFP	ENCLOSED FRAME PORCH	RECRM	RECREATION ROOM
EMP	ENCLOSED MASONRY PORCH	S	SHED
FB	FINISHED BASEMENT	SQFT	SQUARE FOOT
FDN	FOUNDATION	STRG	STORAGE
G	GARAGE	UFB	UNFINISHED BASEMENT
GH	GREENHOUSE	WD	DECK

EXAMPLE SKETCH

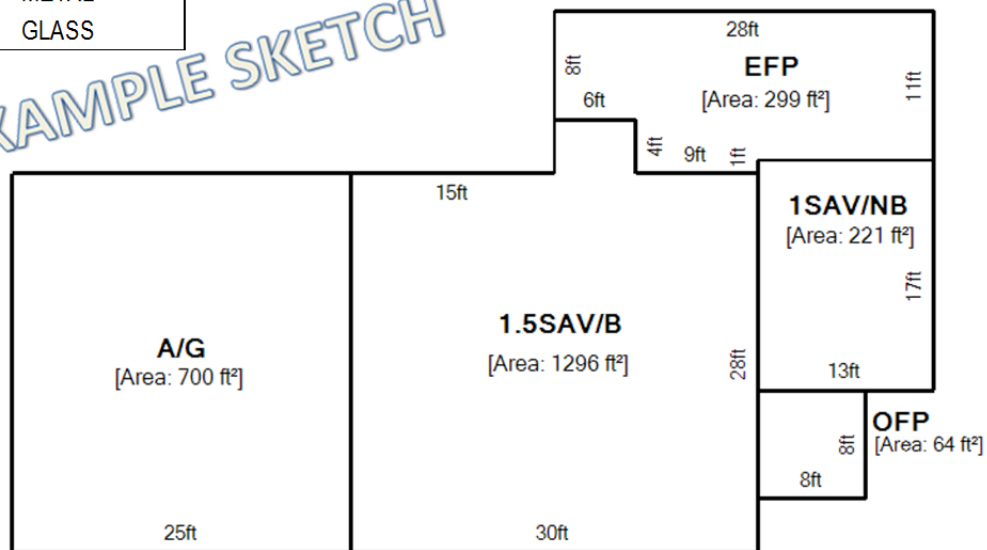

Information on this site is used for tax assessment purposes only and is subject to change without prior notice. The County of Lehigh Assessment Office assumes no responsibility for the use of the information for any other purpose. The use of information for any other purpose other than for tax assessment purposes is the sole and exclusive responsibility of the individual or entity using the information.