

County of Lehigh Online Records Access
Property Details

Street View

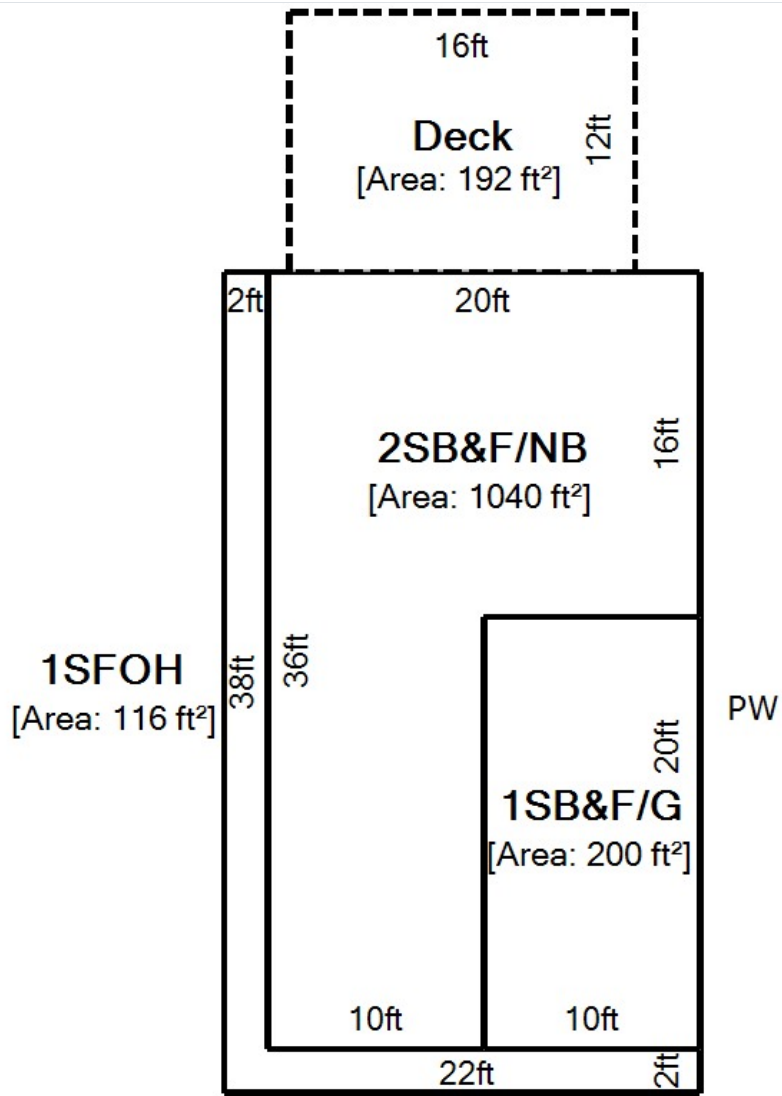



Property Overview

| 2026 | | | | | | | | | | | | | | | | | | | | | | | | | | |
|------------------------------|---|------------------|--------------|------------------|-------|-----------------|--------|------------------|--------|----------|-----------|---------------|---------|--|-----------|-------------|--------------|-----------|----------|--|-----------|-------|--|--|--|-------------|
| Owner Name | URENA YORYI RODRIGUEZ & N V C JARRIN | | | | | | | | | | | | | | | | | | | | | | | | | |
| Owner Address | 853 N HALSTEAD ST ALLENTOWN PA 18109-1840 | | | | | | | | | | | | | | | | | | | | | | | | | |
| Property Address | 853 N HALSTEAD ST ALLENTOWN PA 18109 | | | | | | | | | | | | | | | | | | | | | | | | | |
| Parcel Viewer | View in Parcel Viewer | | | | | | | | | | | | | | | | | | | | | | | | | |
| Low Number | 0853 | | | | | | | | | | | | | | | | | | | | | | | | | |
| High Number | 0853 | | | | | | | | | | | | | | | | | | | | | | | | | |
| Tax Authority | CITY OF ALLENTOWN | | | | | | | | | | | | | | | | | | | | | | | | | |
| School District | ALLENTOWN SCHOOL DISTRICT | | | | | | | | | | | | | | | | | | | | | | | | | |
| Parcel Id | 640787594997 1 | | | | | | | | | | | | | | | | | | | | | | | | | |
| Old Parcel Id | 02 15 G10NW2D 007 015 | | | | | | | | | | | | | | | | | | | | | | | | | |
| Tile | 476004C | | | | | | | | | | | | | | | | | | | | | | | | | |
| Acres/Dimension | 28.33 X 120 | | | | | | | | | | | | | | | | | | | | | | | | | |
| Lot Sq Ft | 3400 | | | | | | | | | | | | | | | | | | | | | | | | | |
| Utilities | PUBLIC WATER/SEWER | | | | | | | | | | | | | | | | | | | | | | | | | |
| Class | RESIDENTIAL | | | | | | | | | | | | | | | | | | | | | | | | | |
| Land Use | SINGLE FAMILY - END OF ROW | | | | | | | | | | | | | | | | | | | | | | | | | |
| Living Units | 1 | | | | | | | | | | | | | | | | | | | | | | | | | |
| Zoning | N3 | | | | | | | | | | | | | | | | | | | | | | | | | |
| Homestead Act 72 | Application Approved and Enrolled - 02/18/2020 | | | | | | | | | | | | | | | | | | | | | | | | | |
| Preferential Land Act | NO | | | | | | | | | | | | | | | | | | | | | | | | | |
| Agricultural Easement | NO | | | | | | | | | | | | | | | | | | | | | | | | | |
| Assessment Base Year | 2013 | | | | | | | | | | | | | | | | | | | | | | | | | |
| Total Assessment | <table border="1"> <tbody> <tr> <td>Exempt Land</td> <td>0</td> </tr> <tr> <td>Exempt Building</td> <td>0</td> </tr> <tr> <td>Taxable Land</td> <td>11,800</td> </tr> <tr> <td>Taxable Building</td> <td>91,900</td> </tr> <tr> <td>Total</td> <td>103,700</td> </tr> <tr> <td>Taxable Total</td> <td>103,700</td> </tr> </tbody> </table> | Exempt Land | 0 | Exempt Building | 0 | Taxable Land | 11,800 | Taxable Building | 91,900 | Total | 103,700 | Taxable Total | 103,700 | | | | | | | | | | | | | |
| Exempt Land | 0 | | | | | | | | | | | | | | | | | | | | | | | | | |
| Exempt Building | 0 | | | | | | | | | | | | | | | | | | | | | | | | | |
| Taxable Land | 11,800 | | | | | | | | | | | | | | | | | | | | | | | | | |
| Taxable Building | 91,900 | | | | | | | | | | | | | | | | | | | | | | | | | |
| Total | 103,700 | | | | | | | | | | | | | | | | | | | | | | | | | |
| Taxable Total | 103,700 | | | | | | | | | | | | | | | | | | | | | | | | | |
| Estimated Taxes | <table border="1"> <thead> <tr> <th></th> <th>Mills (Land)</th> <th>Mills (Building)</th> <th>Mills</th> <th>Estimated Taxes</th> </tr> </thead> <tbody> <tr> <td>County</td> <td></td> <td></td> <td>3.780000</td> <td>\$ 391.99</td> </tr> <tr> <td>School</td> <td></td> <td></td> <td>22.643200</td> <td>\$ 2,348.10</td> </tr> <tr> <td>Municipality</td> <td>24.470500</td> <td>4.629300</td> <td></td> <td>\$ 714.18</td> </tr> <tr> <td>Total</td> <td></td> <td></td> <td></td> <td>\$ 3,454.27</td> </tr> </tbody> </table> <p>Tax calculations do not reflect any reduction received due to enrollment in Homestead Act 72</p> | | Mills (Land) | Mills (Building) | Mills | Estimated Taxes | County | | | 3.780000 | \$ 391.99 | School | | | 22.643200 | \$ 2,348.10 | Municipality | 24.470500 | 4.629300 | | \$ 714.18 | Total | | | | \$ 3,454.27 |
| | Mills (Land) | Mills (Building) | Mills | Estimated Taxes | | | | | | | | | | | | | | | | | | | | | | |
| County | | | 3.780000 | \$ 391.99 | | | | | | | | | | | | | | | | | | | | | | |
| School | | | 22.643200 | \$ 2,348.10 | | | | | | | | | | | | | | | | | | | | | | |
| Municipality | 24.470500 | 4.629300 | | \$ 714.18 | | | | | | | | | | | | | | | | | | | | | | |
| Total | | | | \$ 3,454.27 | | | | | | | | | | | | | | | | | | | | | | |
| Bill Number | 021500907 | | | | | | | | | | | | | | | | | | | | | | | | | |
| LC_PropertyAddress | 853 N HALSTEAD ST ALLENTOWN PA 18109 | | | | | | | | | | | | | | | | | | | | | | | | | |

Basic Residential Profile

| | |
|--------------------------|----------------------------|
| Type of Residence | SINGLE FAMILY - END OF ROW |
| Number of Stories | 2 STORY |

| | |
|---------------------------------|-------------------|
| Type of Construction | BRICK & FRAME |
| Type of Basement | NO |
| Type of Heating/Cooling | BASE |
| Type of Garage | ATTACHED ONE CAR |
| Number of Full Bathrooms | 1 |
| Number of Half Bathrooms | 0 |
| Fireplaces | 0 |
| Square Feet | 1356 |
| Year Built | 1954 |
| Pool | NO POOL |
| Implement Buildings | NO IMPLEMENT BLDG |

Residential Profile Data With No Influence on Assessment Value

| | |
|---------------------------|---|
| Total Rooms | 6 |
| Number of Bedrooms | 2 |
| Family Rooms | 1 |

Sales History

| Sale Date | Owner Name | Document Id | Sale Price |
|-----------|--------------------------------------|-------------|------------|
| 05/2019 | URENA YORYI RODRIGUEZ & N V C JARRIN | 2019012881 | \$ 119,500 |
| 12/2018 | GRIST MILL DEVELOPMENT COMPANY LLC | 2018035593 | \$ 50,000 |
| 07/1998 | FEGLEY LINDA M | 1612/0521 | \$ 47,000 |
| 00/0000 | MILLER GERALD A | 1158/0992 | \$ 0 |

The building sketch represents the actual exterior measurement of the structure as measured from the outside. The sketch will show any attached areas and will be labeled with a descriptive code. Measurements are rounded to the nearest foot. Certain sketch dimensions and angles are drawn in approximation to their actual measurements.

The total square-foot area includes only the assessed living area of a residential structure, generally areas that are heated and/or cooled. Living area does not include porches, decks, patios, or garages.

Some of the common abbreviations are listed below for reference:

| BUILDING STYLE | |
|----------------|-------------|
| CODE | DESCRIPTION |
| 1S | 1 STORY |
| 1.5S | 1½ STORY |
| 2S | 2 STORY |
| 2.5S | 2½ STORY |
| 3S | 3 STORY |
| 3.5S | 3½ STORY |
| B-L | BI-LEVEL |
| S-L | SPLIT-LEVEL |

| EXTERIOR | |
|----------|-------------------|
| CODE | DESCRIPTION |
| AV, A, V | ALUMINUM OR VINYL |
| B | BRICK |
| B&F | BRICK & FRAME |
| BFR | BRICK FRONT |
| BTR | BRICK TRIM |
| C | CONCRETE |
| CB | CONCRETE BLOCK |
| F, FR | FRAME |
| ST | STONE |
| SD | STUCCO OR DRYVIT |
| MTL | METAL |
| GL | GLASS |

| CODE | DESCRIPTION | CODE | DESCRIPTION |
|------|------------------------|-------|---------------------|
| A | ATTIC | IGP | INGROUND POOL |
| BAL | BALCONY | LD | LOADING DOCK |
| B | BASEMENT | MP | MASONRY PATIO |
| BAY | BAY | MS | MASONRY SLAB |
| BSG | BASEMENT GARAGE | NB | NO BASEMENT |
| BW | BREEZEWAY | NA | NOT ADDED |
| BLT | BUILT | NI | NOT INCLUDED |
| CP | CARPORT | OFP | OPEN FRAME PORCH |
| CPY | CANOPY | OMP | OPEN MASONRY PORCH |
| CC | CATHEDRAL CEILING | OH | OVERHANG |
| CRLS | CRAWL SPACE | PB | PART BASEMENT |
| DECK | DECK | PW | PARTY WALL |
| EFP | ENCLOSED FRAME PORCH | RECRM | RECREATION ROOM |
| EMP | ENCLOSED MASONRY PORCH | S | SHED |
| FB | FINISHED BASEMENT | SQFT | SQUARE FOOT |
| FDN | FOUNDATION | STRG | STORAGE |
| G | GARAGE | UFB | UNFINISHED BASEMENT |
| GH | GREENHOUSE | WD | DECK |

EXAMPLE SKETCH



Information on this site is used for tax assessment purposes only and is subject to change without prior notice. The County of Lehigh Assessment Office assumes no responsibility for the use of the information for any other purpose. The use of information for any other purpose other than for tax assessment purposes is the sole and exclusive responsibility of the individual or entity using the information.