

County of Lehigh Online Records Access
Property Details

Street View

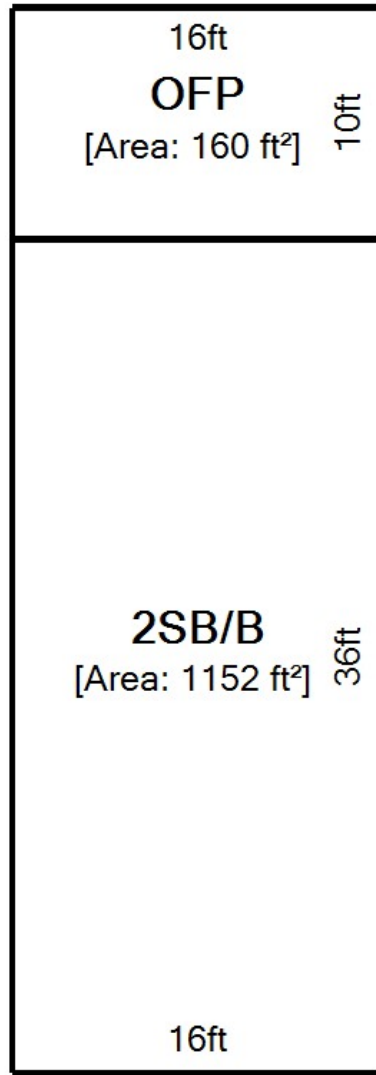



Property Overview

2026																										
Owner Name	RENOVALES ARLENE																									
Owner Address	1923 S DELAWARE ST ALLENTOWN PA 18103-8523																									
Property Address	1923 S DELAWARE ST ALLENTOWN PA 18103																									
Parcel Viewer	View in Parcel Viewer																									
Low Number	1923																									
High Number	1923																									
Sub Division	WESTBROOK PARK																									
Tax Authority	CITY OF ALLENTOWN																									
School District	ALLENTOWN SCHOOL DISTRICT																									
Parcel Id	640621667944 1																									
Old Parcel Id	02 19 H09SE3A 004 009																									
Tile	466014A																									
Acres/Dimension	38.48 X 119.64 IRREG																									
Lot Sq Ft	4046																									
Utilities	PUBLIC WATER/SEWER																									
Class	RESIDENTIAL																									
Land Use	SINGLE FAMILY - END OF ROW																									
Living Units	1																									
Zoning	N3																									
Homestead Act 72	Application Approved and Enrolled - 02/02/2015																									
Preferential Land Act	NO																									
Agricultural Easement	NO																									
Assessment Base Year	2013																									
Total Assessment	<table border="1"> <tr> <td>Exempt Land</td> <td></td> <td>0</td> </tr> <tr> <td>Exempt Building</td> <td></td> <td>0</td> </tr> <tr> <td>Taxable Land</td> <td></td> <td>13,300</td> </tr> <tr> <td>Taxable Building</td> <td></td> <td>84,700</td> </tr> <tr> <td>Total</td> <td></td> <td>98,000</td> </tr> <tr> <td>Taxable Total</td> <td></td> <td>98,000</td> </tr> </table>	Exempt Land		0	Exempt Building		0	Taxable Land		13,300	Taxable Building		84,700	Total		98,000	Taxable Total		98,000							
Exempt Land		0																								
Exempt Building		0																								
Taxable Land		13,300																								
Taxable Building		84,700																								
Total		98,000																								
Taxable Total		98,000																								
Estimated Taxes	<table border="1"> <thead> <tr> <th></th> <th>Mills (Land)</th> <th>Mills (Building)</th> <th>Mills</th> <th>Estimated Taxes</th> </tr> </thead> <tbody> <tr> <td>County</td> <td></td> <td></td> <td>3.780000</td> <td>\$ 370.44</td> </tr> <tr> <td>School</td> <td></td> <td></td> <td>22.643200</td> <td>\$ 2,219.03</td> </tr> <tr> <td>Municipality</td> <td>24.470500</td> <td>4.629300</td> <td></td> <td>\$ 717.56</td> </tr> <tr> <td>Total</td> <td></td> <td></td> <td></td> <td>\$ 3,307.03</td> </tr> </tbody> </table> <p>Tax calculations do not reflect any reduction received due to enrollment in Homestead Act 72</p>		Mills (Land)	Mills (Building)	Mills	Estimated Taxes	County			3.780000	\$ 370.44	School			22.643200	\$ 2,219.03	Municipality	24.470500	4.629300		\$ 717.56	Total				\$ 3,307.03
	Mills (Land)	Mills (Building)	Mills	Estimated Taxes																						
County			3.780000	\$ 370.44																						
School			22.643200	\$ 2,219.03																						
Municipality	24.470500	4.629300		\$ 717.56																						
Total				\$ 3,307.03																						
Bill Number	021901652																									
LC_PropertyAddress	1923 S DELAWARE ST ALLENTOWN PA 18103																									

Basic Residential Profile

Type of Residence	SINGLE FAMILY - END OF ROW
--------------------------	----------------------------

Number of Stories	2 STORY
Type of Construction	BRICK
Type of Basement	FULL
Type of Heating/Cooling	BASE
Type of Garage	BASEMENT ONE CAR
Number of Full Bathrooms	1
Number of Half Bathrooms	0
Fireplaces	0
Square Feet	1152
Year Built	1957
Pool	NO POOL
Implement Buildings	NO IMPLEMENT BLDG

Residential Profile Data With No Influence on Assessment Value

Total Rooms	6
Number of Bedrooms	3
Family Rooms	0

Sales History

Sale Date	Owner Name	Document Id	Sale Price
04/2014	RENOVALES ARLENE	2014009872	\$ 52,500
01/2014	FEDERAL HOME LOAN MORTGAGE CORP	2014002706	\$ 1,521
03/2005	KURTZ LISA D	7250884	\$ 94,950
07/2002	JACKSON EVELYN M	7016272	\$ 68,000
06/1988	LERCH ROBERT C & LINDA J	1420/1093	\$ 1

The building sketch represents the actual exterior measurement of the structure as measured from the outside. The sketch will show any attached areas and will be labeled with a descriptive code. Measurements are rounded to the nearest foot. Certain sketch dimensions and angles are drawn in approximation to their actual measurements.

The total square-foot area includes only the assessed living area of a residential structure, generally areas that are heated and/or cooled. Living area does not include porches, decks, patios, or garages.

Some of the common abbreviations are listed below for reference:

BUILDING STYLE	
CODE	DESCRIPTION
1S	1 STORY
1.5S	1½ STORY
2S	2 STORY
2.5S	2½ STORY
3S	3 STORY
3.5S	3½ STORY
B-L	BI-LEVEL
S-L	SPLIT-LEVEL

EXTERIOR	
CODE	DESCRIPTION
AV, A, V	ALUMINUM OR VINYL
B	BRICK
B&F	BRICK & FRAME
BFR	BRICK FRONT
BTR	BRICK TRIM
C	CONCRETE
CB	CONCRETE BLOCK
F, FR	FRAME
ST	STONE
SD	STUCCO OR DRYVIT
MTL	METAL
GL	GLASS

CODE	DESCRIPTION	CODE	DESCRIPTION
A	ATTIC	IGP	INGROUND POOL
BAL	BALCONY	LD	LOADING DOCK
B	BASEMENT	MP	MASONRY PATIO
BAY	BAY	MS	MASONRY SLAB
BSG	BASEMENT GARAGE	NB	NO BASEMENT
BW	BREEZEWAY	NA	NOT ADDED
BLT	BUILT	NI	NOT INCLUDED
CP	CARPORT	OFP	OPEN FRAME PORCH
CPY	CANOPY	OMP	OPEN MASONRY PORCH
CC	CATHEDRAL CEILING	OH	OVERHANG
CRLS	CRAWL SPACE	PB	PART BASEMENT
DECK	DECK	PW	PARTY WALL
EFP	ENCLOSED FRAME PORCH	RECRM	RECREATION ROOM
EMP	ENCLOSED MASONRY PORCH	S	SHED
FB	FINISHED BASEMENT	SQFT	SQUARE FOOT
FDN	FOUNDATION	STRG	STORAGE
G	GARAGE	UFB	UNFINISHED BASEMENT
GH	GREENHOUSE	WD	DECK

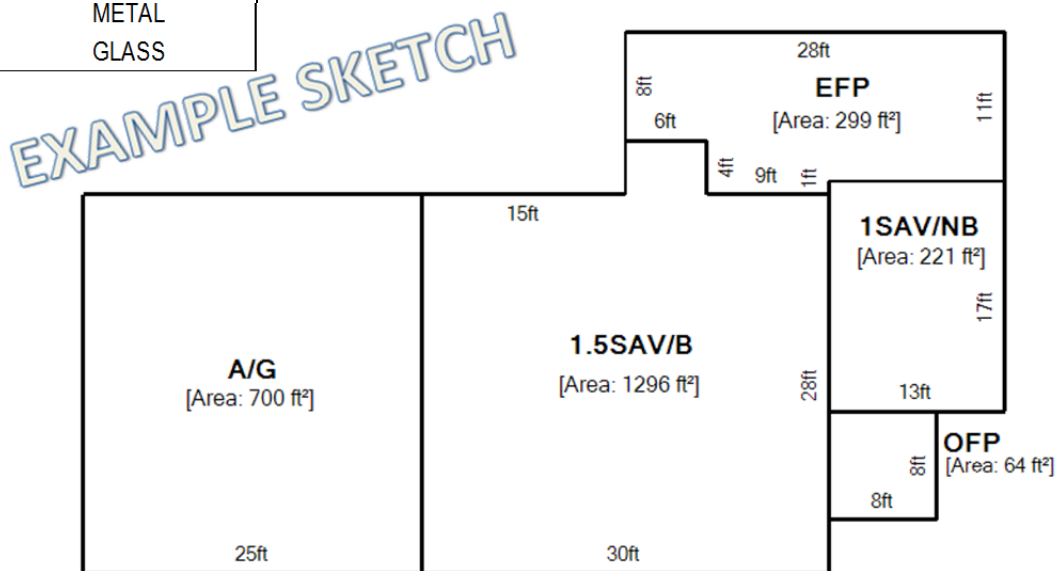

Information on this site is used for tax assessment purposes only and is subject to change without prior notice. The County of Lehigh Assessment Office assumes no responsibility for the use of the information for any other purpose. The use of information for any other purpose other than for tax assessment purposes is the sole and exclusive responsibility of the individual or entity using the information.